

Specifications:
 Housing: LCP UL94-V0
 Contact: Phosphor Bronze
 Operating Voltage: 50V AC/DC
 Current Rating: 1.0A AC/DC
 Withstand Voltage: 500V AC/Minute
 Contact Resistance: $\leq 20m\Omega$
 Insulation resistance: $\geq 100m\Omega$
 Operating Temperature: $-25^{\circ}\text{C} \sim +85^{\circ}\text{C}$

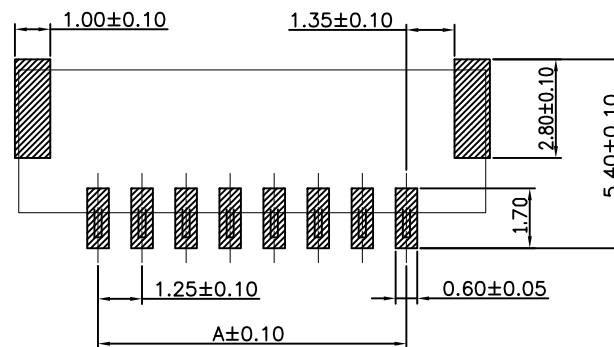
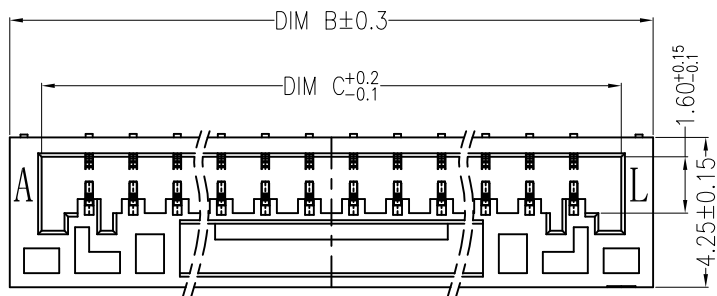
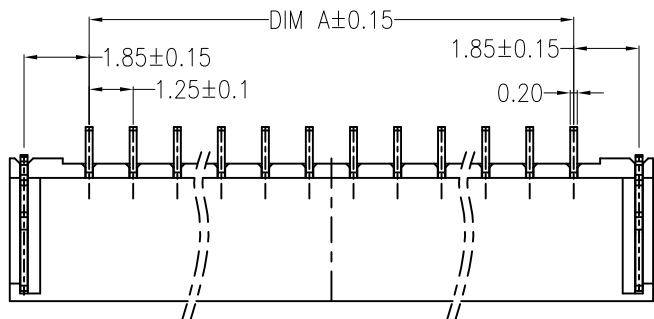

SUGGESTED PCB LAYOUT
(COMPONENT SIDE)

孔位	尺寸	DIM A	DIM B	DIM C	DIM E
2P		1.25	5.75	3.75	0.75
3P		2.50	7.00	5.00	1.60
4P		3.75	8.25	6.25	2.65
5P		5.00	9.50	7.50	2.50
6P		6.25	10.75	8.75	4.65
7P		7.50	12.00	10.00	4.65
8P		8.75	13.25	11.25	4.65
9P		10.00	14.50	12.50	4.65
10P		11.25	15.75	13.75	6.60
11P		12.50	17.00	15.00	6.60
12P		13.75	18.25	16.25	6.60
13P		15.00	19.50	17.50	6.60
14P		16.25	20.75	18.75	6.60
15P		17.50	22.00	20.00	6.60

一般公差
TOLERANCES
 X. ± 0.40 .XX ± 0.20
 .X ± 0.30 .XXX ± 0.10
 ANGLES $\pm 2^{\circ}$

深圳市宏利电子有限公司
Shenzhen Holy Electronic Co.,Ltd

检验尺寸标示
SYMBOLS \odot \ominus INDICATE CLASSIFICATION DIMENSION

工程图号
GH125TB-nP

制图 (DR)
'08/5/16

\odot MARK IS CRITICAL DIM.
 \ominus MARK IS MAJOR DIM.

品名
GH1.25-nP 卧贴

审核 (CHKD)

TITLE
GH1.25mm Pitch TB FOR SMT CONN

核准 (APPD)
Rigo Lu

表面处理 (FINISH)

比例 (SCALE)
1:1

单位 (UNITS)
mm

张数 (SHEET)
1 OF 1

尺寸 (SIZE)
A4

版本 (REV)
0

修订 REV	修改摘要 REVISION DESCRIPTION	日期 DATE	签名 SIGNATURE