

Specifications:
 Operating Voltage: 250V AC/DC
 Current Rating: 3A AC/DC
 Withstand Voltage: 1000V AC/Minute
 Contact Resistance: $\leq 30\text{m}\Omega$
 Insulation resistance: $\geq 1000\text{m}\Omega$
 Operating Temperature: $-25^{\circ}\text{C} \sim +85^{\circ}\text{C}$

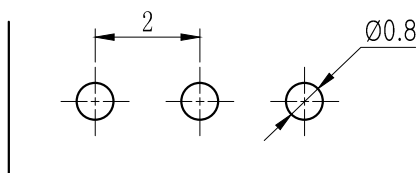
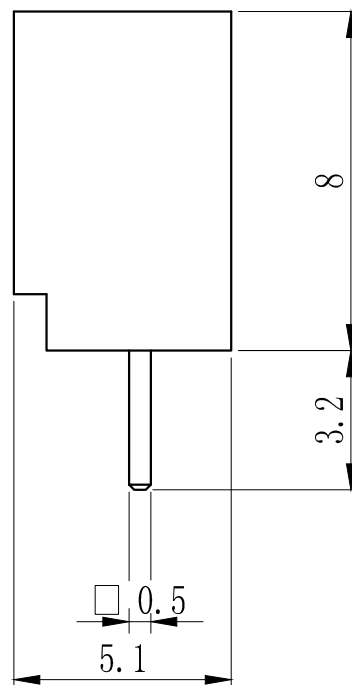
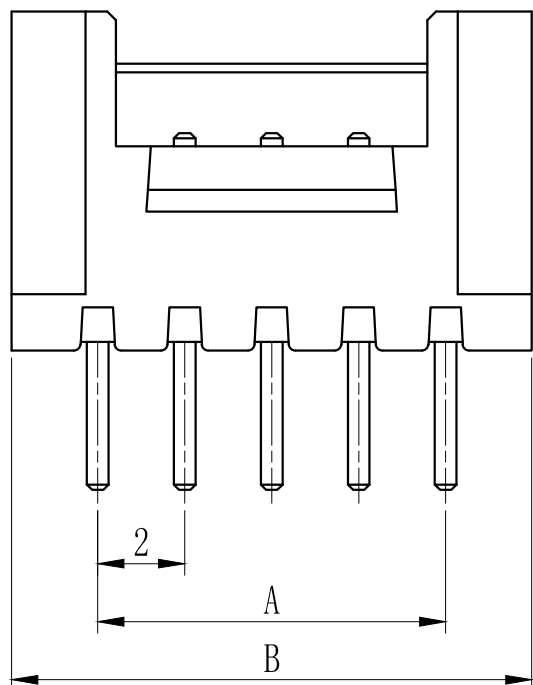

P. C. B LAYOUT

P数	尺寸 (mm)	
	A	B
2	2.00	6.00
3	4.00	8.00
4	6.00	10.00
5	8.00	12.00
6	10.00	14.00
7	12.00	16.00
8	14.00	18.00
9	16.00	20.00
10	18.00	22.00
11	20.00	24.00
12	22.00	26.00
13	24.00	28.00
14	26.00	30.00
15	28.00	32.00
16	30.00	34.00

一般公差 TOLERANCES		深圳市宏利电子有限公司 Shenzhen Holy Electronic Co.,Ltd	
X. ± 0.40	.XX ± 0.20	工程图号	HY20-nA
.X ± 0.30	.XXX ± 0.10	品名	HY2.0-nA 直针
ANGLES $\pm 2^{\circ}$		TITLE	HY2.0mm Pitch A DIP CONN
检验尺寸标示	SYMBOLS \odot \ominus INDICATE CLASSIFICATION DIMENSION	比例 (SCALE)	1:1
\odot MARK IS CRITICAL DIM.	\ominus MARK IS MAJOR DIM.	单位 (UNITS)	mm
表面处理 (FINISH)		张数 (SHEET)	1 OF 1
		尺寸 (SIZE)	A4
		审核 (CHKD)	Rigo Lu
		制图 (DR)	*10/03/22
		修改 (APPD)	
		签名 (SIGNATURE)	
		日期 (DATE)	
		修订 (REV)	

修订 (REV)	修改摘要 (REVISION DESCRIPTION)	日期 (DATE)	签名 (SIGNATURE)
-	-	-	-